

All floor drains must be 2-piece commercial drains with a waterproofing flange.

If the concrete is touching the drain, break out the concrete 1" deep around the drain and clean the drain so that the metal is exposed.

Fill with EEMS0240 Acid Resistant Epoxy Mortar Patch/Resurfacer. Plug drain prior to filler to prevent blockage.

Ensure that floor drains are set no higher than 1/8 inch above slab

Everlast Industrial Floor 1/8" minimal thickness

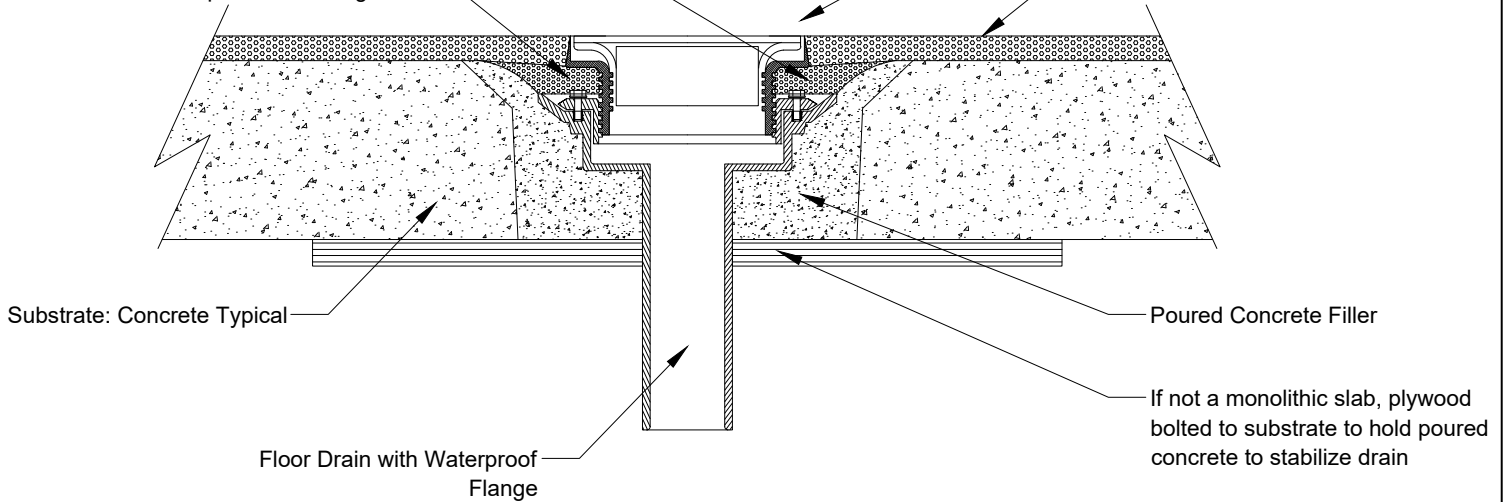

ARCHITECTURAL DETAIL

Everlast Industrial Floor waterproof drain detail



EVERLAST®
EPOXY

Healthy ● Durable ● Attractive

803 S Garden St, Columbia, TN 38401
Phone: (800) 708-9870
Email: care@everlastepoxy.com
www.everlastepoxy.com

SCALE

Not to Scale

DATE

2025.05.29

DRAWING NUMBER

EI-Drain-01