

Zinc, Aluminum, or Stainless Steel L Angle floor divider strip  
 Everlast Epoxy floor 1/8" - 3/8" typical thickness

Finished Floor same thickness as Everlast Epoxy floor

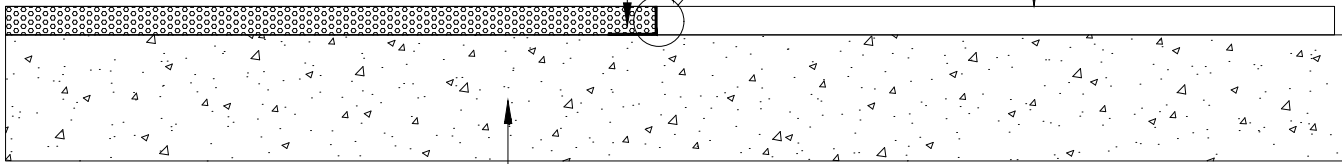

Substrate: Concrete Typical

ARCHITECTURAL DETAIL

## Epoxy floor transition to other floor detail



Healthy ● Durable ● Attractive

803 S Garden St, Columbia, TN 38401  
 Phone: (800) 708-9870  
 Email: [care@everlastepoxy.com](mailto:care@everlastepoxy.com)  
[www.everlastepoxy.com](http://www.everlastepoxy.com)

SCALE

Not to Scale

DATE

2025.05.29

DRAWING NUMBER

EF-Transition-03